

JET SPRAY

CARE AND CLEANING INSTRUCTIONS JET SPRAY VISUAL DISPENSERS

1 TURN OFF ALL SWITCHES REFRIGERATION AND SPRAY

DRAIN REMAINING BEVERAGE FROM BOWLS

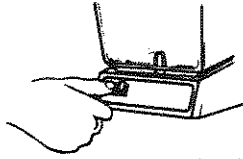

9 LOCK PUMP HOUSING INTO BOWL

Push straight down until pump snaps into place. PUMP HOUSING MUST LOCK SECURELY INTO BOWL

CAUTION: BOTH TABS MUST SNAP INTO PLACE.

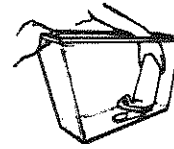

2 REMOVE THE PINCH TUBE

Push handle back until it stops. This will release the tube which can then be lifted out.

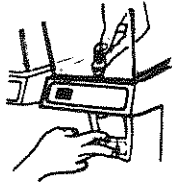

10 REPLACE BOWL

Slide bowl assembly over cooling coils, push down solidly to secure.

IMPORTANT: BE SURE BOWL GASKET AND BOWL SPOUT GASKET ARE IN PLACE AND WET BEFORE INSTALLING BOWL.

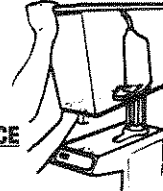

3 REMOVE PUSH HANDLES

Push handle back until it stops, grasp the white clips and squeeze. Pull handle straight down.



11 REPLACE PUSH HANDLES

Push straight up through opening until the clips snap into place.



4 a. REMOVE CONDENSATE DRAIN

Squeeze both sides and pull straight down.

b. REMOVE DRIP TRAY ASSEMBLY
Pull straight out from base of unit.

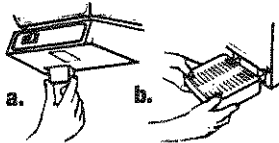

12 REPLACE PINCH TUBES

a) Wet tube, push handle back, insert tube through hole inside bowl. Tube end should pass below the end of the spout.
b) Grasp end of tube and pull down, this will seat the tube in the bowl.



5 DISASSEMBLE BOWL ASSEMBLY

Remove bowl cover, pump housing assembly and bowl from base. Check impeller to be sure it spins freely. If not remove and clean.

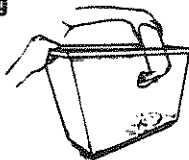

13 REPLACE CONDENSATE DRAIN

Insert into space provided. Drain snaps into place. BE SURE THE SLOTTED OPENING IS PLACED TOWARD FRONT PANEL OF UNIT.

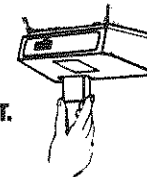

6 THOROUGHLY CLEAN ALL PARTS IN WARM WATER USING A MILD NON-ABRASIVE DETERGENT, RINSE THOROUGHLY

CAUTION: ABRASIVE WILL SCRATCH PLASTIC PARTS

14 REPLACE DRIP TRAY ASSEMBLY

Insert straight into slots provided on front of base.

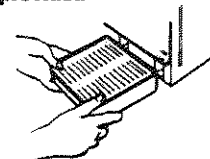

7 RE-ASSEMBLE PUMP HOUSING ASSEMBLY

a) Spray tube locks in by pushing down and turning clockwise
b) Re-install impeller and pin.

BE SURE IMPELLER SPINS FREELY ON SHAFT.

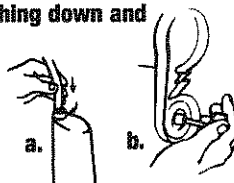

15 REFILL BOWL

Follow beverage manufacturer's directions. Turn on refrigeration and spray switches. Beverage should be cold enough to serve in approx. 2 hrs.

NOTE: TO INSURE EFFICIENT OPERATION DISPENSER SHOULD REMAIN ON 24 HOURS PER DAY.

8 WITH BOWL UPSIDE DOWN INSERT GASKET INTO GROOVE AND PRESS INTO PLACE

Wetting the gasket eases installation.



For more information call or write to:

JET SPRAY

IMI Cornelius/JetSpray Corp.
500 Regency Drive, Glendale Heights, IL 60139
Telephone: 800-238-3600 • www.cornelius.com